

SEC 23, TWN 18N, RGE 2W, W.M., OLYMPIA, WASHINGTON

# PRITCHARD REHABILITATION AND EXPANSION

## DES PROJECT 22-554 (A)

### SCHEMATIC DESIGN

#### SURVEY INFORMATION

#### LEGAL DESCRIPTION

SYLVESTER DC FT CAPITAL CAMPUS BORDERED ON N BY S LN PATERS ONS CAP

#### BASIS OF BEARING

CITY OF OLYMPIA COORDINATE SYSTEM

#### VERTICAL DATUM

NAVD 88 CONTRACTOR TO VERIFY VERTICAL DATUM WITH TIES TO TOPOGRAPHIC FEATURES PRIOR TO START OF CONSTRUCTION.

#### UTILITY NOTES

UTILITIES SHOWN HEREON ARE PER KPFF ON SITE SURVEY OF SURFACE FEATURES IN CONJUNCTION WITH UNDERGROUND UTILITY LOCATES PERFORMED BY MT. VIEW LOCATING. ALL UTILITIES SHOWN HEREON SHOULD BE CONSIDERED APPROXIMATE ONLY, AS WELL AS AS-BUILT DATA ON FILE AT THE OFFICE OF KPFF.

#### BOUNDARY NOTES

BOUNDARY INFORMATION SHOWN HEREON IS PER BEST AVAILABLE RECORD INFORMATION. NO TITLE REPORT WAS OBTAINED BY THIS SURVEY AND NO EASEMENTS OF RECORD ARE SHOWN HEREON.

#### SURVEY NOTES

CONTROL SURVEY PERFORMED USING GPS/RTK METHODS WITH THE USE OF TOPCON GRS RECEIVERS, SUPPLEMENTAL CONTROL SURVEY AND TOPOGRAPHIC SURVEY PERFORMED USING A TOPCON GT-503 TOTAL STATION.

THE SURVEY WORK PERFORMED DURING THE COURSE OF THIS SURVEY MEETS OR EXCEEDS THE STANDARDS AS SET FORTH IN WAC 332-130-090.

SURVEY WORK PERFORMED IN DECEMBER OF 2021.

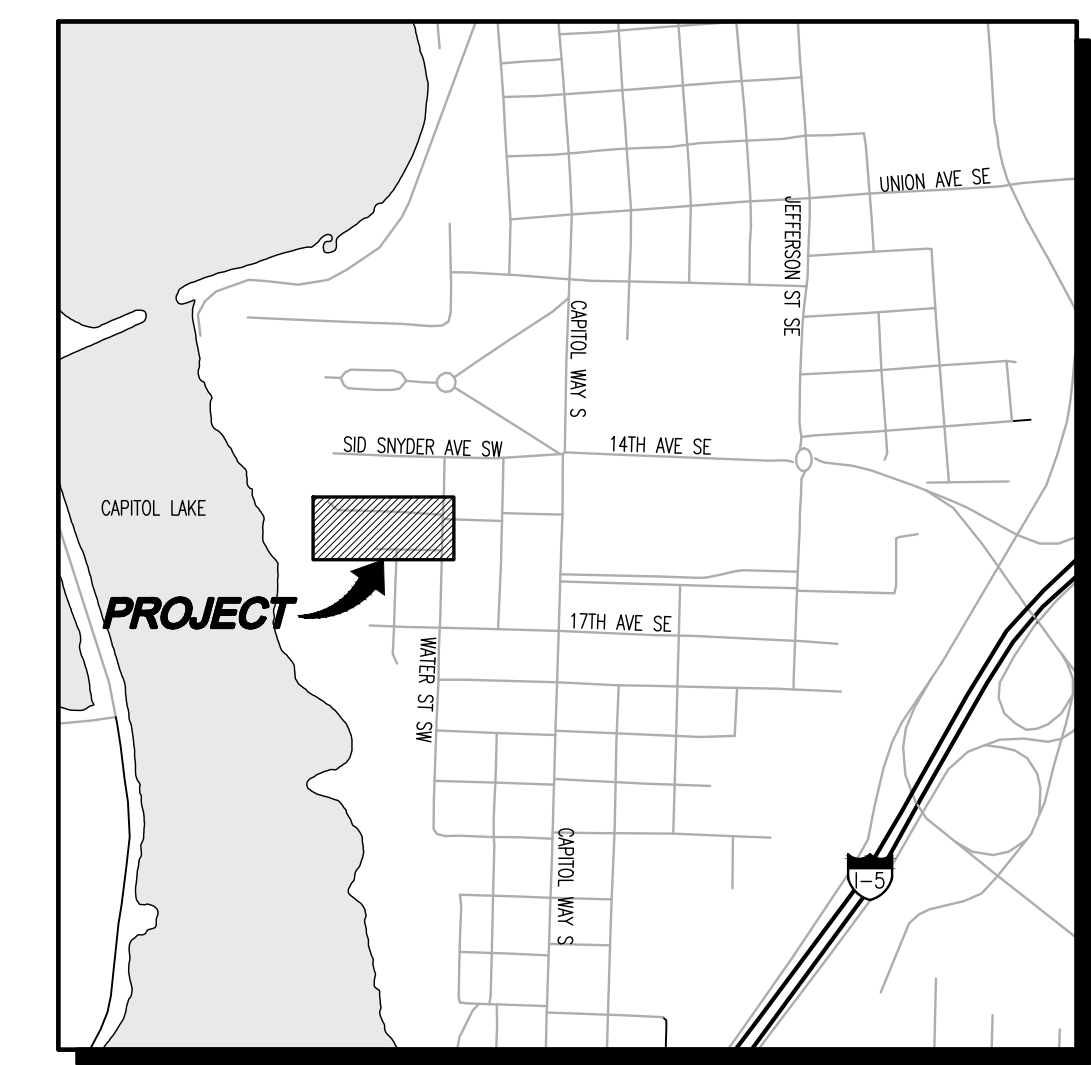
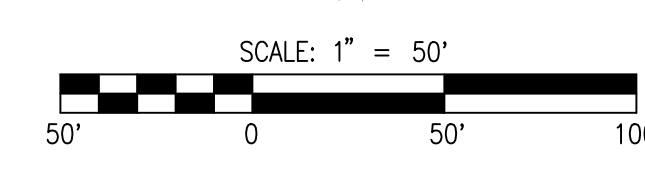
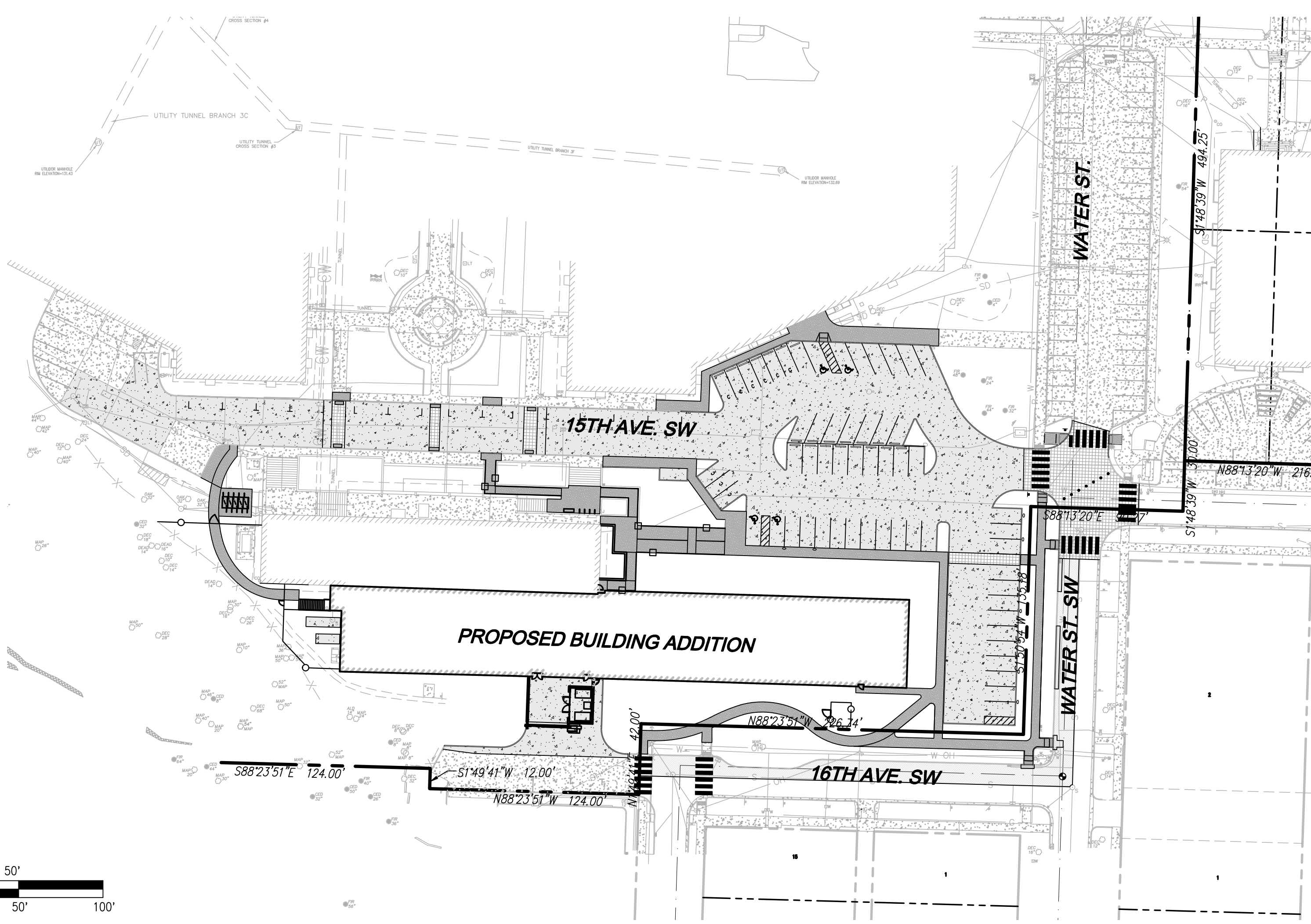

VICINITY MAP  
SCALE: 1"=1000'

#### LEGEND AND ABBREVIATIONS

##### EXISTING SYMBOLS

SYMBOL	DESCRIPTION
[Symbol]	CONTROL POINTS
[Symbol]	POWER VAULT
[Symbol]	TRANSFORMER
[Symbol]	POWER METER
[Symbol]	LIGHT JUNCTION BOX
[Symbol]	POWER JUNCTION BOX
[Symbol]	POWER POLE
[Symbol]	STREET LIGHT W/ ARM
[Symbol]	LIGHT POLE
[Symbol]	YARD LIGHT
[Symbol]	GUY ANCHOR
[Symbol]	TELEPHONE POLE
[Symbol]	TELECOMMUNICATIONS MAN HOLE
[Symbol]	TELECOMMUNICATIONS VAULT
[Symbol]	TELECOMMUNICATIONS PEDESTAL
[Symbol]	WATER VAULT
[Symbol]	FIRE DEPARTMENT CONNECTION
[Symbol]	POST INDICATOR VALVE
[Symbol]	FIRE HYDRANT
[Symbol]	WATER METER
[Symbol]	WATER VALVE
[Symbol]	IRRIGATION VALVE
[Symbol]	WATER MANHOLE
[Symbol]	WATER SPIGOT
[Symbol]	GAS METER
[Symbol]	GAS VALVE
[Symbol]	SANITARY SEWER MAN HOLE
[Symbol]	SEWER CLEANOUT
[Symbol]	STORM DRAIN MAN HOLE
[Symbol]	CATCH BASIN
[Symbol]	CLEANOUT
[Symbol]	BOLLARD
[Symbol]	MAILBOX
[Symbol]	SIGN AS NOTED
[Symbol]	CONIFER AS NOTED
[Symbol]	DECIDUOUS AS NOTED
[Symbol]	BUSH
[Symbol]	WHEEL STOP
[Symbol]	MONUMENT LINE
[Symbol]	VACATED
[Symbol]	PROPERTY LINE
[Symbol]	CENTER LINE
[Symbol]	RIGHT OF WAY
[Symbol]	BUILDING OVERHANG
[Symbol]	FENCE AS NOTED
[Symbol]	EDGE OF PAVEMENT
[Symbol]	EDGE OF GRAVEL
[Symbol]	SANITARY SEWER
[Symbol]	STORM DRAIN
[Symbol]	OVERHEAD UTILITY
[Symbol]	GAS LINE
[Symbol]	WATER LINE
[Symbol]	CHILLED WATER LINE
[Symbol]	UNDERGROUND POWER
[Symbol]	UNDERGROUND TELECOMMUNICATIONS
[Symbol]	TRUNCATED DOME HATCH
[Symbol]	BUILDING HATCH
[Symbol]	CONCRETE HATCH

##### PROPOSED STORM SYMBOLS

SYMBOL	DESCRIPTION
[Symbol]	SD CAP
[Symbol]	TYPE 1 CATCH BASIN, GRATED LID
[Symbol]	TYPE 1 CATCH BASIN, SOLID LID
[Symbol]	TYPE 2 CATCH BASIN, GRATED LID
[Symbol]	TYPE 2 CATCH BASIN, SOLID LID
[Symbol]	BEEHIVE MANHOLE COVER
[Symbol]	SQUARE YARD DRAIN
[Symbol]	ROUND YARD DRAIN
[Symbol]	STORM CLEAN OUT
[Symbol]	STORM PIPE

##### PROPOSED SEWER SYMBOLS

SYMBOL	DESCRIPTION
[Symbol]	SEWER CAP
[Symbol]	SEWER CLEANOUT
[Symbol]	SEWER MANHOLE
[Symbol]	SEWER PIPE

##### PROPOSED WATER SYMBOLS

SYMBOL	DESCRIPTION
[Symbol]	WATER CAP
[Symbol]	CONCRETE BLOCKING
[Symbol]	BUTTERFLY VALVE
[Symbol]	11" BEND
[Symbol]	45" BEND
[Symbol]	90" BEND
[Symbol]	22" BEND
[Symbol]	VALVE
[Symbol]	HYDRANT ASSEMBLY
[Symbol]	BLOW-OFF VALVE
[Symbol]	REDUCER
[Symbol]	AIR-VAC ASSEMBLY
[Symbol]	WATER METER
[Symbol]	WATER PIPE

#### PROJECT INFORMATION

TAX PARCELS: 09850005000  
 SITE ADDRESS: 415 15TH AVE SW  
 SITE AREA: 937,847 SF (21.53 AC)  
 CURRENT ZONING: CAPITOL CAMPUS  
 PROPOSED ZONING: CAPITOL CAMPUS  
 PROPOSED LAND USE: GOVERNMENT  
 PROPOSED UNITS: 1 BUILDING EXPANSION  
 WATER: CITY OF OLYMPIA  
 SEWER: CITY OF OLYMPIA  
 POWER: PUGET SOUND ENERGY  
 GAS: PUGET SOUND ENERGY  
 TELEPHONE: COMCAST OR CENTURYLINK  
 CABLE: COMCAST  
 FIRE DISTRICT: OLYMPIA

#### CONTACT LIST

**OWNER:**  
 WASHINGTON STATE DEPARTMENT OF ENTERPRISE SERVICES  
 1500 JEFFERSON ST  
 OLYMPIA, WA 98504  
 CONTACT: CLARISSA EASTON, AIA  
 PHONE: (360) 701-0088  
 EMAIL: clarissa.easton@des.wa.gov

**ARCHITECT:**  
 DLR GROUP  
 51 UNIVERSITY ST, SUITE 600  
 SEATTLE, WA 98101  
 CONTACT: ERICA CEDER, LEED AP BD+C, ASSOC. DBA  
 PHONE: (503) 274-2675  
 EMAIL: eceder@dlrgroup.com

**CIVIL ENGINEER:**  
 LDC, INC.  
 1411 STATE AVE NE, #200  
 OLYMPIA, WASHINGTON 98506  
 CONTACT: ROSS D. JARVIS, PE  
 PHONE: (425) 806-1869  
 FAX: (425) 482-2883  
 EMAIL: rjarvis@ldccorp.com

**SURVEYOR:**  
 KPFF  
 612 WOODLAND SQUARE LOOP SE, SUITE 100  
 LACEY, WA 98503  
 CONTACT: JEROME CHAPMAN  
 PHONE: (360) 292-7230  
 EMAIL: jerome.chapman@kpff.com

#### TABLE OF CONTENTS

- CV-01 COVER SHEET
- EX-01 EXISTING CONDITIONS MAP
- EC-01 DEMOLITION AND TESC PLAN
- SP-01 SITE IMPROVEMENT PLAN
- SD-01 GRADING AND DRAINAGE PLAN
- UT-01 WATER AND SEWER PLAN
- FR-01 16TH AVE FRONTAGE IMPROVEMENTS
- FR-02 WATER ST FRONTAGE IMPROVEMENTS

NO.	DATE	REVISIONS DESCRIPTION	BY

**LDC** | Surveying  
Engineering  
Planning

Olympia  
1411 State Ave NE #200  
Olympia, WA 98506  
www.LDCcorp.com

Kent  
1423 482-2893

Woodville  
1411 State Ave NE #200  
Olympia, WA 98506  
www.LDCcorp.com  
T: 425.806.1869

WA DEPARTMENT OF ENTERPRISE SERVICES

**PRITCHARD REHABILITATION AND EXPANSION**

COVER SHEET

**ROSS D. JARVIS**  
 1988  
 PROFESSIONAL ENGINEER  
 WA-262-2299

JOB NUMBER: C22-261  
 DRAWING NAME: C22-261 CV-01  
 DESIGNER: RW  
 DRAFTING BY: EO  
 DATE: MARCH 2023  
 SCALE: AS NOTED  
 JURISDICTION: OLYMPIA

**CV-01**

SHEET 1 OF 8







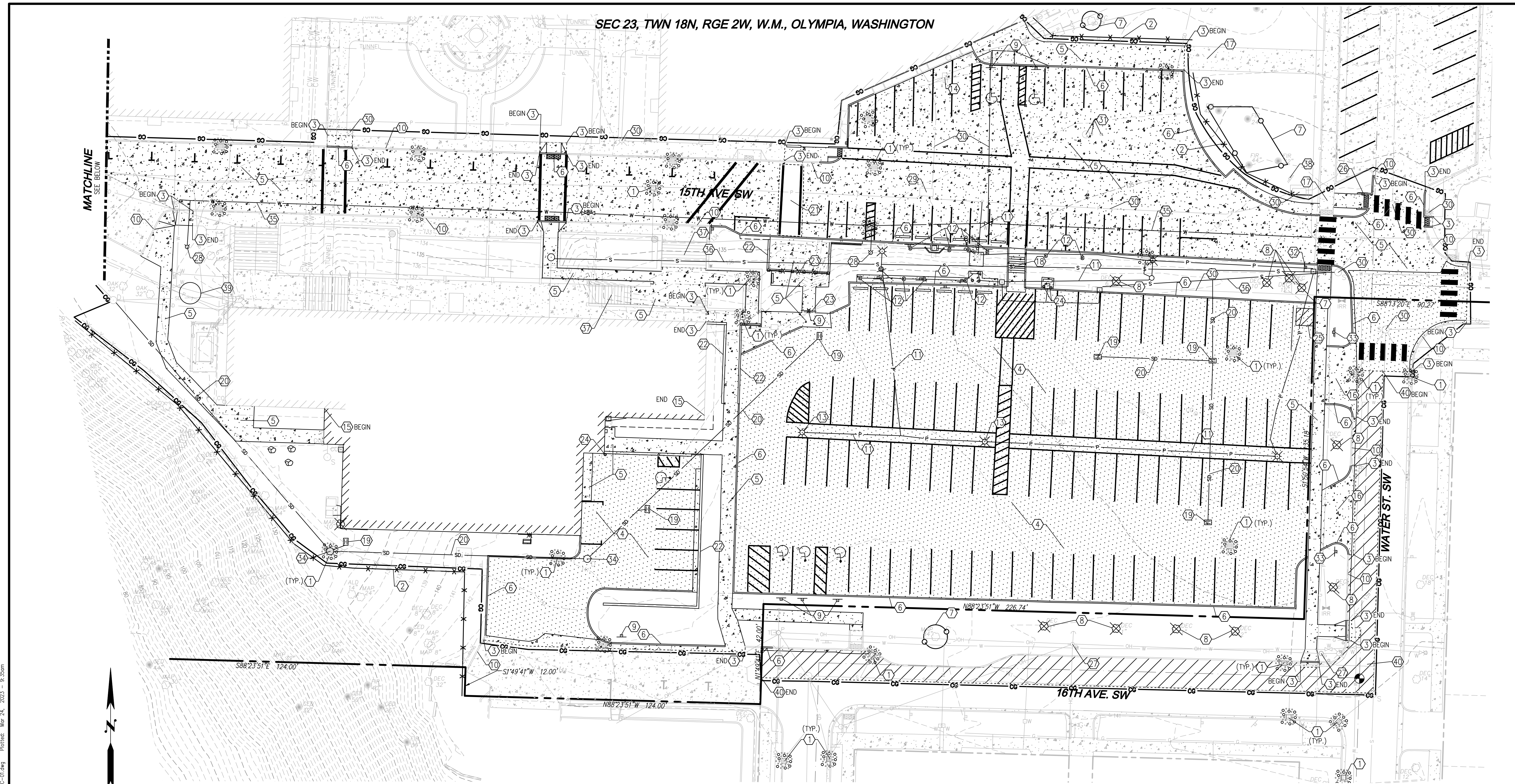

Drawing: P:\03\2022\02-261 pritchard and expansion\Drawings\Construction\02-261 EC-01.dwg Printed: Mar 24, 2023 - 8:35am

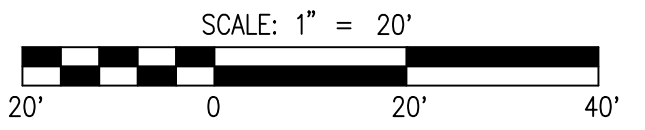

**LEGEND**

	CLEARING LIMITS
	SILT FENCE
	STORM DRAIN INLET PROTECTION
	SAWCUT
	PAVEMENT REMOVAL
	CONCRETE REMOVAL
	GRIND & OVERLAY
	TREE TO BE REMOVED
	TREE PROTECTION FENCING

- DEMOLITION AND EROSION CONTROL NOTES**
1. INSTALL STORM DRAIN INLET PROTECTION
  2. INSTALL SILT FENCE
  3. SAWCUT
  4. REMOVE AND DISPOSE OF EXISTING ASPHALT AND BASE
  5. REMOVE AND DISPOSE OF EXISTING CONCRETE AND BASE
  6. REMOVE AND DISPOSE OF EXISTING CONCRETE CURB
  7. INSTALL TREE PROTECTION FENCING
  8. REMOVE AND DISPOSE OF EXISTING TREE INCLUDING STUMP AND ROOT BALL
  9. REMOVE EXISTING SIGN POST AND FOUNDATION
  10. PROTECT IN-PLACE EXISTING CURB
  11. REMOVE EXISTING UNDERGROUND POWER LINE AND BACKFILL TO 95% COMPACTION
  12. REMOVE EXISTING ELECTRIC VEHICLE CHARGING STATION, SIGN, AND POWER LINE
  13. REMOVE AND DISPOSE OF EXISTING LIGHT POLE AND BASE
  14. PROTECT IN-PLACE EXISTING JUNCTION BOX, RAISE LID TO FINISHED GRADE
  15. REMOVE PORTION OF BUILDING FOR BUILDING ADDITION, SEE ARCHITECTURAL PLANS FOR BUILDING DEMOLITION PLAN
  16. REMOVE EXISTING DRIVEWAY
  17. PROTECT IN-PLACE EXISTING SIDEWALK
  18. REMOVE AND DISPOSE OF EXISTING STAIRS
  19. REMOVE AND DISPOSE OF EXISTING CATCH BASIN AND BACKFILL TO 95% COMPACTION
  20. REMOVE EXISTING STORM DRAIN LINE AND BACKFILL TO 95% COMPACTION
  21. REMOVE AND DISPOSE OF EXISTING SPEED BUMP
  22. REMOVE AND DISPOSE OF EXISTING RETAINING WALL
  23. REMOVE AND DISPOSE OF EXISTING FENCE
  24. REMOVE AND DISPOSE OF EXISTING BOLLARD
  25. REMOVE PARKING ATTENDANT BUILDING. CONTRACTOR TO COORDINATE REMOVAL/RELOCATION WITH OWNER
  26. RELOCATE EXISTING PEDESTRIAN CROSSING SIGN
  27. PROTECT IN-PLACE EXISTING POWER POLE
  28. REMOVE AND DISPOSE OF EXISTING HYDRANT
  29. PROTECT IN-PLACE EXISTING POWER VAULT, ADJUST LID TO FINISHED GRADE
  30. PROTECT IN-PLACE EXISTING UTILITY UNLESS OTHERWISE NOTED.
  31. RAISE EXISTING FUEL LID TO FINISHED GRADE
  32. REMOVE EXISTING STOP SIGN POST AND FOUNDATION
  33. REMOVE EXISTING EMPLOYEE RESERVED PARKING LOT SIGN POST AND FOUNDATION. CONTRACTOR TO COORDINATE WITH OWNER ON REMOVAL/RELOCATION.
  34. REMOVE AND DISPOSE OF EXISTING STORM MANHOLE AND BACKFILL TO 95% COMPACTION
  35. REMOVE AND DISPOSE OF EXISTING WATER LINE AND BACKFILL TO 95% COMPACTION
  36. REMOVE AND DISPOSE OF EXISTING SEWER LINE AND BACKFILL TO 95% COMPACTION
  37. PROTECT IN-PLACE EXISTING STAIRS
  38. PROTECT IN-PLACE EXISTING SIGN
  39. REMOVE EXISTING BICYCLE LOCKERS
  40. GRIND & OVERLAY

- CONSTRUCTION SEQUENCE**
1. ATTEND PRE-CONSTRUCTION MEETING WITH OWNER, CONTRACTOR, DESIGN ENGINEER, AND INSPECTOR.
  2. TEMPORARY EROSION CONTROL MEASURES TO BE IN PLACE AND INSPECTED PRIOR TO ANY CONSTRUCTION OR SITE CLEARING. INSTALL SILT FENCING AND FLAG CLEARING LIMITS. INSTALL CONSTRUCTION ENTRANCE.
  3. ARRANGE FOR CITY TO INSPECT AND APPROVE CLEARING LIMIT FLAGGING PRIOR TO CLEARING.
  4. INSTALL REMAINING TESC MEASURES AS SHOWN.
  5. BEGIN CLEARING AND GRADING.
  6. CONSTRUCT PERMANENT DETENTION VAULT OR TEMPORARY SEDIMENT POND AND MAINTAIN DURING CONSTRUCTION.
  7. ROUGH GRADE, CONSTRUCT WALLS AND INSTALL UTILITIES.
  8. INSTALL FINAL PAVING, CURBING AND SIDEWALK.
  9. STABILIZE UNPAVED AREAS WITH LANDSCAPING OR HYDROSEEDING AS PERMANENT COVER AND AS REQUIRED PER BMP 15.13.
  10. CLEAN OUT STORM SYSTEM AND STRUCTURES WHEN CONSTRUCTION IS COMPLETE.
  11. ALL TEMPORARY EROSION AND SEDIMENT CONTROL MEASURES SHALL BE REMOVED WITHIN 30 DAYS AFTER FINAL SITE STABILIZATION IS ACHIEVED OR AFTER THE TEMPORARY BMP'S ARE NO LONGER NEEDED. TRAPPED SEDIMENT SHALL BE REMOVED OR STABILIZED ON SITE. DISTURBED SOIL AREAS RESULTING FROM REMOVAL SHALL BE PERMANENTLY STABILIZED.



**REVISIONS**

NO.	DATE	DESCRIPTION	BY

**LDC** | Surveying  
Engineering  
Planning

Olympia  
1411 State Avenue NE #200  
Olympia, WA 98506  
T 425.896.1869  
www.LDCcorp.com

Kent  
F 425.482.2851

WA DEPARTMENT OF ENTERPRISE SERVICES  
**PRITCHARD REHABILITATION AND EXPANSION**  
DEMOLITION AND TESC PLAN

**EC-01**

SHEET 3 OF 8

JOB NUMBER: 022-261  
DRAWING NAME: 022-261 EC-01  
DESIGNER: RW  
DRAFTING BY: EO  
DATE: MARCH 2023  
SCALE: AS NOTED  
JURISDICTION: OLYMPIA



**LDC** | Surveying  
Engineering  
Planning

Olympia  
1411 State Avenue NE #200  
Olympia, WA 98506  
T 425.896.1869  
www.LDCcorp.com

Kent  
F 425.482.2851

PRITCHARD REHABILITATION AND EXPANSION

100% SCHEMATIC DESIGN  
03/29/2023  
REVISIONS

73-22165-00  
DEMOLITION AND TESC PLAN

EC-01



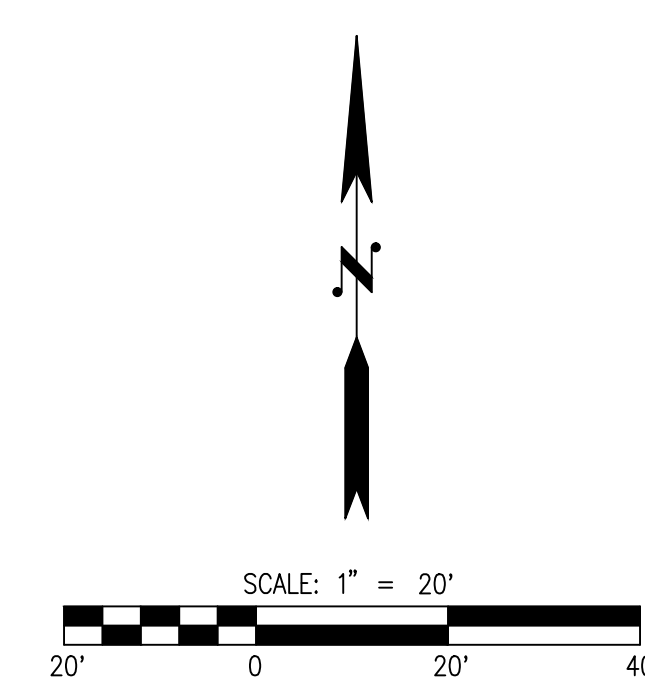
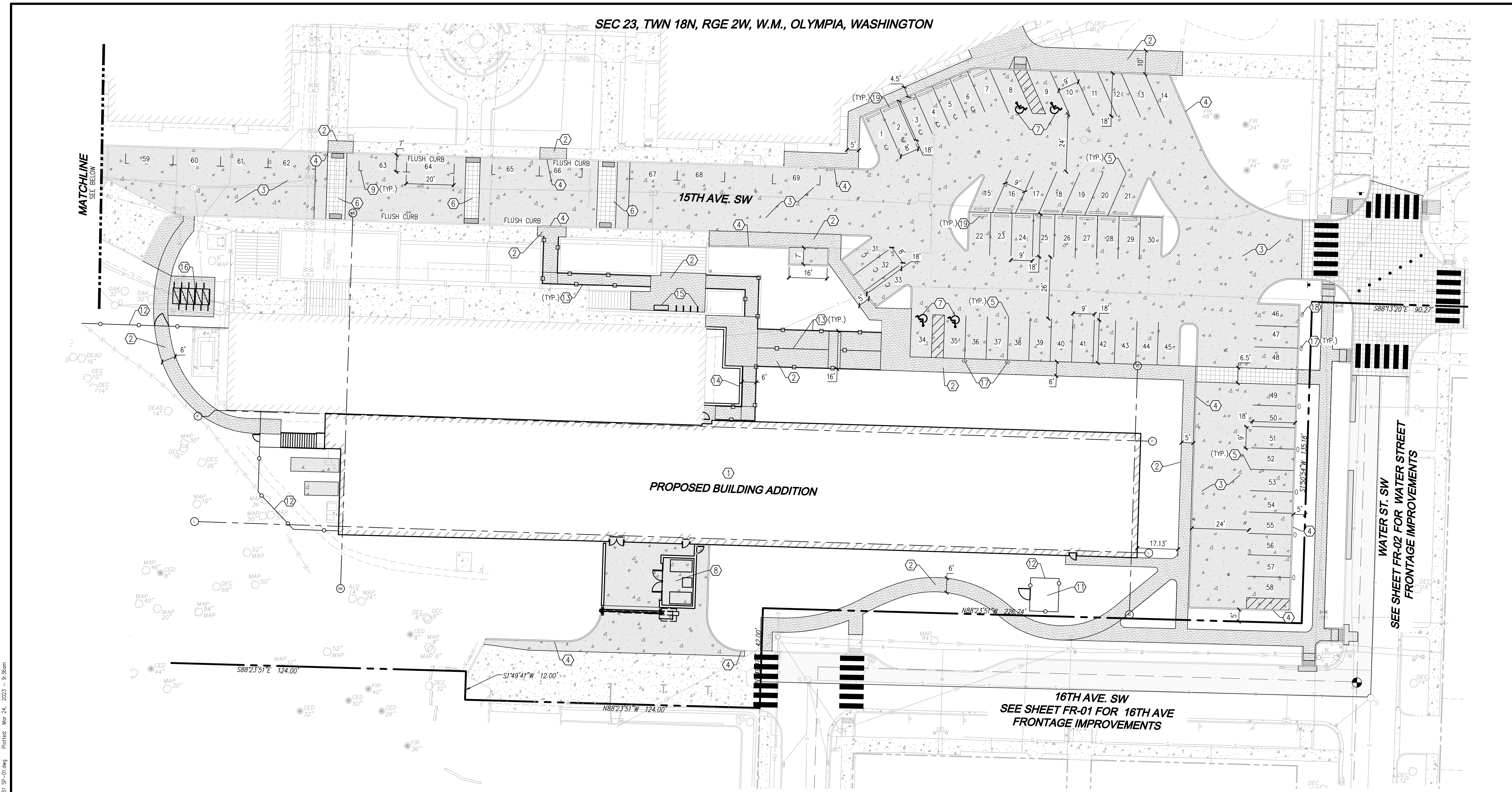

**LEGEND**

	PROPOSED BUILDING
	CONCRETE SIDEWALK
	ASPHALT PAVEMENT
	CONCRETE PAVEMENT
	DECORATIVE CONCRETE PAVEMENT, SEE LANDSCAPE PLANS FOR ADDITIONAL INFORMATION
	GRIND & OVERLAY
	CONCRETE CURB
	STALL COUNT
	PROPOSED CHAINLINK FENCE
	PROPOSED HANDRAIL
	CONCRETE WHEELSTOP

- CONSTRUCTION NOTES**
1. PROPOSED BUILDING ADDITION, SEE ARCHITECTURAL PLANS FOR ADDITIONAL INFORMATION
  2. INSTALL NEW CONCRETE SIDEWALK
  3. INSTALL NEW CONCRETE PAVEMENT
  4. INSTALL NEW CONCRETE CURB
  5. 4" WHITE PARKING STALL PAINT STRIPE
  6. DECORATIVE CONCRETE PAVEMENT, SEE LANDSCAPE PLANS FOR ADDITIONAL INFORMATION
  7. PROPOSED ADA STALL
  8. TRASH ENCLOSURE, SEE ARCHITECTURAL PLANS FOR ADDITIONAL INFORMATION
  9. 4" WIDE PARALLEL PARKING STRIPING
  10. INSTALL PARALLEL ADA RAMP
  11. ELECTRIC VEHICLE CHARGING TRANSFORMER ENCLOSURE
  12. PROPOSED CHAINLINK FENCE, SEE ARCHITECTURAL PLANS FOR ADDITIONAL INFORMATION
  13. PROPOSED HANDRAIL, SEE LANDSCAPE PLANS FOR ADDITIONAL INFORMATION
  14. PROPOSED RETAINING WALL
  15. BIKE RACK, SEE ARCHITECTURAL PLANS FOR ADDITIONAL INFORMATION
  16. BICYCLE LOCKERS, SEE ARCHITECTURAL PLANS FOR ADDITIONAL INFORMATION
  17. DUAL HEAD EV CHARGING STATION
  18. SINGLE HEAD EV CHARGING STATION
  19. INSTALL CONCRETE WHEEL STOP



<p><b>LDC</b>   Surveying Engineering Planning</p> <p>Woodinville 1411 State Avenue NE #200 Olympia, WA 98506 T 425.886.1869 www.LDCcorp.com</p>	<p><b>LDC</b>   WA DEPARTMENT OF ENTERPRISE SERVICES <b>PRITCHARD REHABILITATION AND EXPANSION</b> SITE IMPROVEMENT PLAN</p>
<p>NO. DATE</p> <p>NO. DATE</p>	<p>REVISIONS</p> <p>DESCRIPTION</p>
<p>Job Number: C22-261 Drawing Name: C22-261 SP-01 Designer: RW Drafting By: EO Date: MARCH 2023 Scale: AS NOTED Jurisdiction: OLYMPIA</p> <p><b>SP-01</b></p> <p>SHEET 4 OF 8</p>	<p>ROSS D. JARVIS STATE OF WASHINGTON PROFESSIONAL SURVEYOR NO. 242-0229</p>

Drawing: P:\Cadd\2022\C22-261 pritchard and pjm.l.dbrim rehabilitation and expansion\Drawings\construction\C22-261 SP-01.dwg Plotfile: Mar 24, 2023 - 8:36am



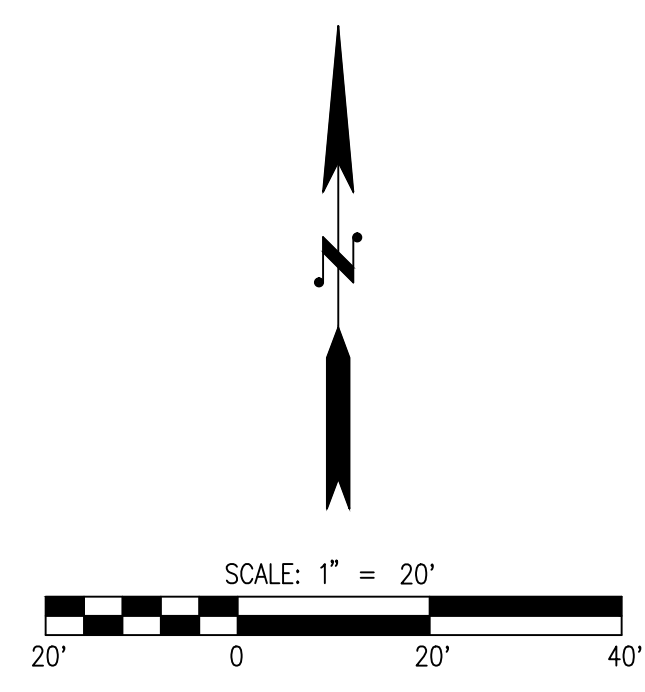
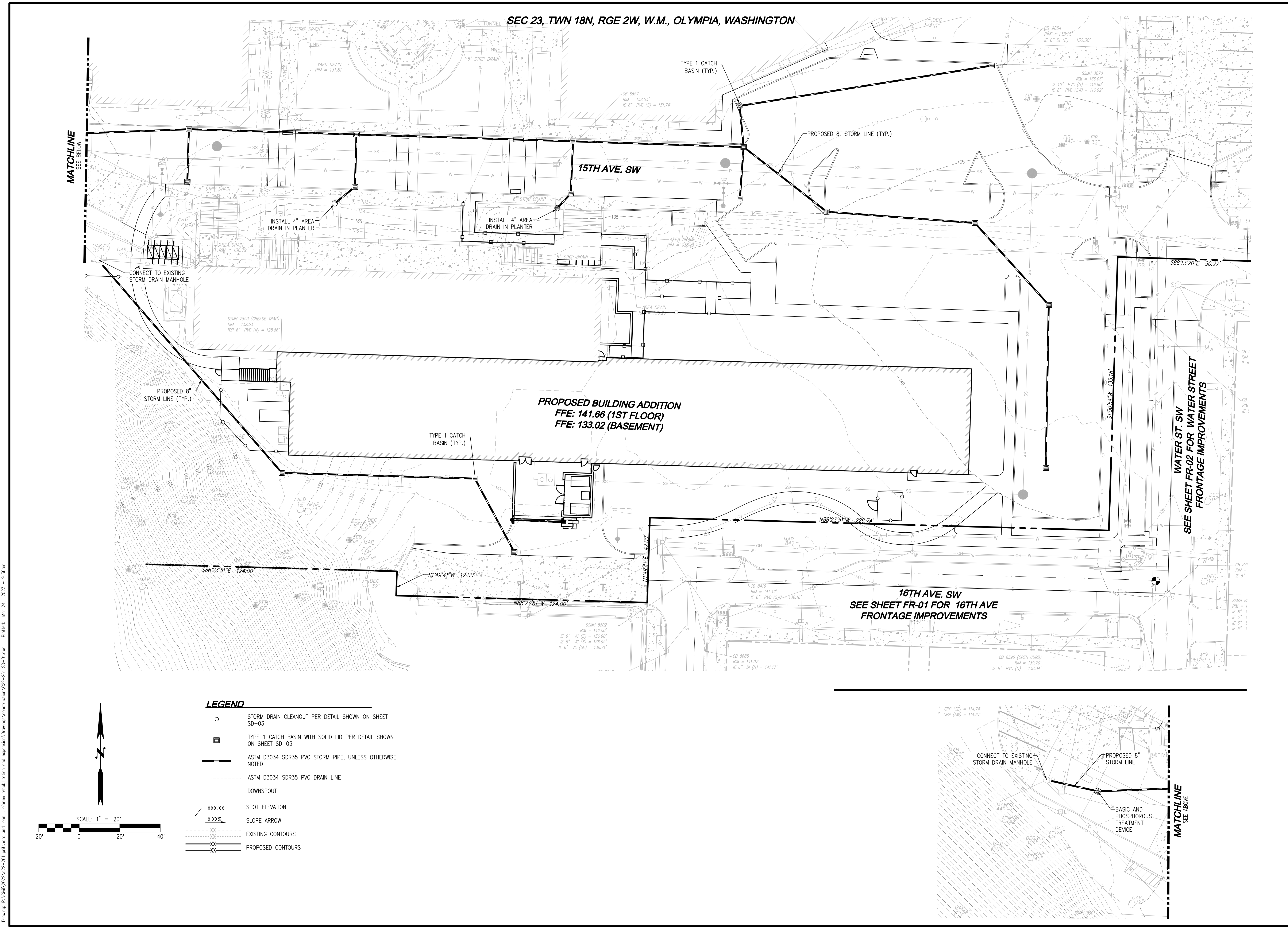

- LEGEND**
- STORM DRAIN CLEANOUT PER DETAIL SHOWN ON SHEET SD-03
  - TYPE 1 CATCH BASIN WITH SOLID LID PER DETAIL SHOWN ON SHEET SD-03
  - ASTM D3034 SDR35 PVC STORM PIPE, UNLESS OTHERWISE NOTED
  - - - - - ASTM D3034 SDR35 PVC DRAIN LINE
  - DOWNSPOUT
  - XXX.XX SPOT ELEVATION
  - X.XXX SLOPE ARROW
  - EXISTING CONTOURS
  - PROPOSED CONTOURS

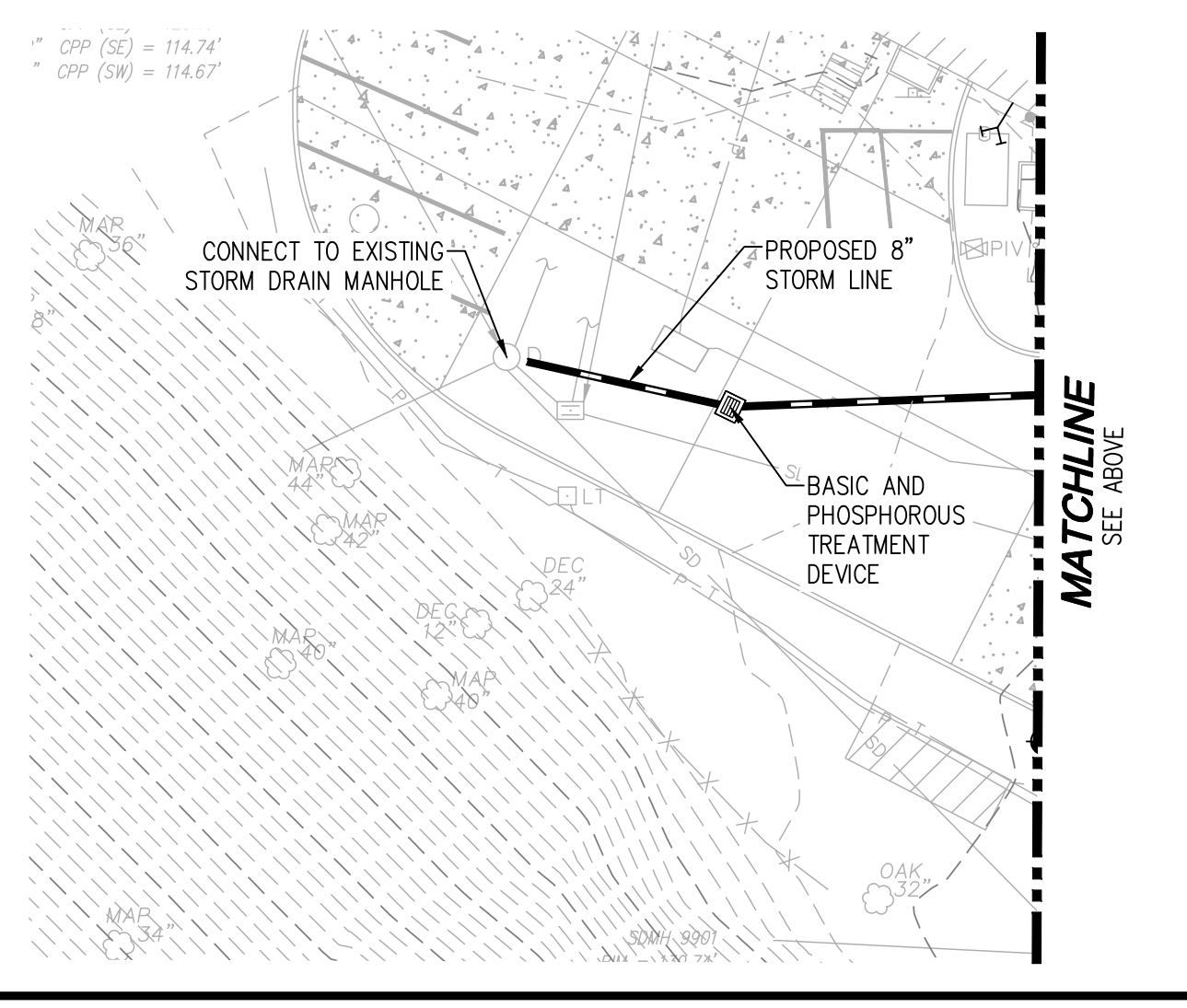

REVISIONS	
NO.	DATE

**LDC**

Surveying  
Engineering  
Planning

Olympia  
1411 State Avenue NE #200  
Olympia, WA 98506  
T 425.896.1869  
www.LDCcorp.com

**LDC**

Surveying  
Engineering  
Planning

Kent  
1411 State Avenue NE #200  
Olympia, WA 98506  
T 425.896.1869  
www.LDCcorp.com

**WA DEPARTMENT OF ENTERPRISE SERVICES**

**PRITCHARD REHABILITATION AND EXPANSION**

**GRADING AND DRAINAGE PLAN**

JOB NUMBER:	C22-261
DRAWING NAME:	C22-261 SD-01
DESIGNER:	RW
DRAFTING BY:	EO
DATE:	MARCH 2023
SCALE:	AS NOTED
JURISDICTION:	OLYMPIA

**SD-01**

SHEET 5 OF 8

Drawing: P:\Users\johnd\OneDrive\Documents\Drawings\Construction\C22-261 SD-01.dwg    Pritched: Mar 24, 2023 - 8:36am

Drawing: P:\Users\johnd\OneDrive\Documents\Drawings\Construction\C22-261 SD-01.dwg    Pritched: Mar 24, 2023 - 8:36am



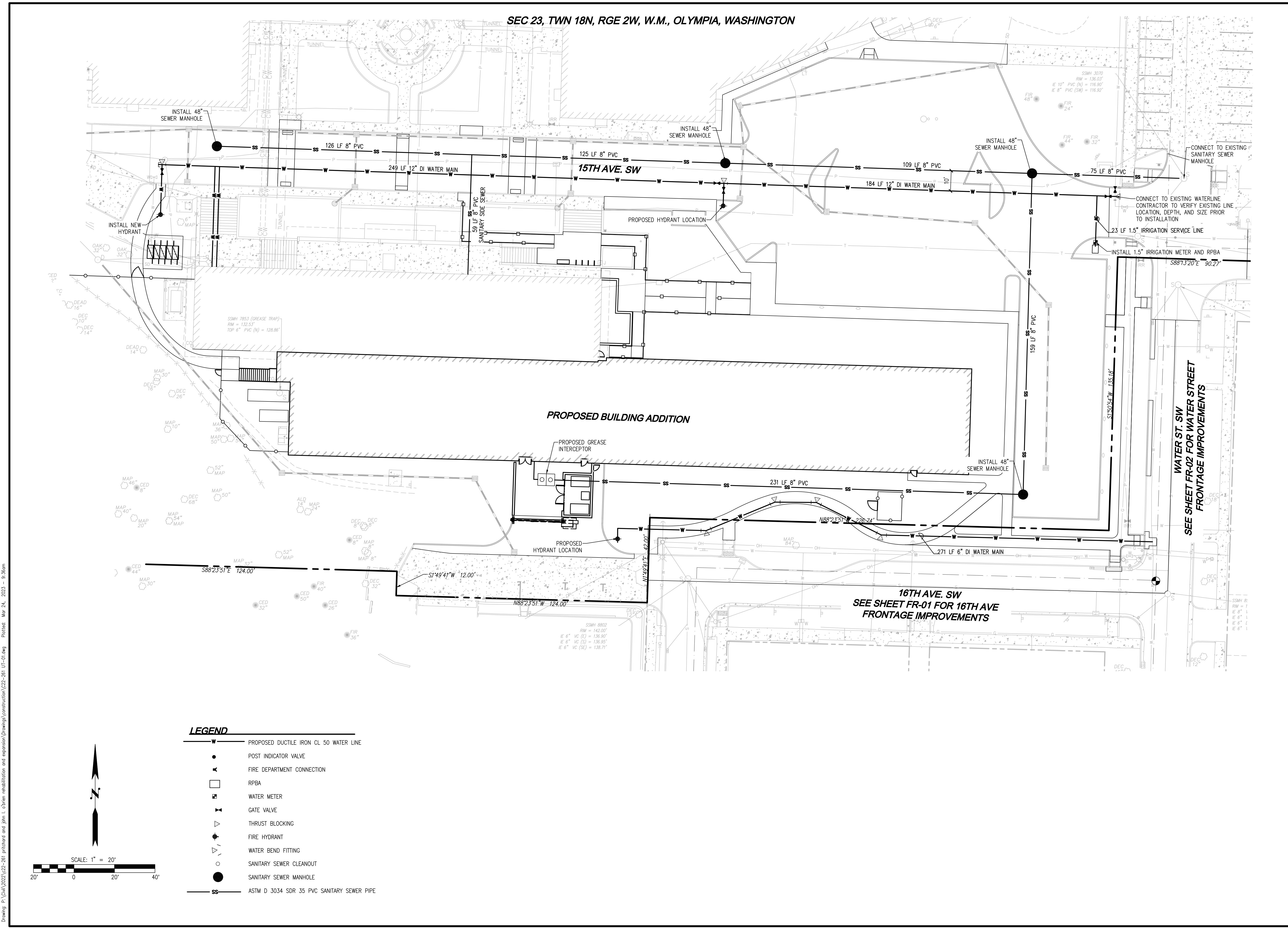

Drawing: E:\Users\jpritchard\Documents\Construction\C22-261 UT-01.dwg Printed: Mar 24, 2023 - 9:36am

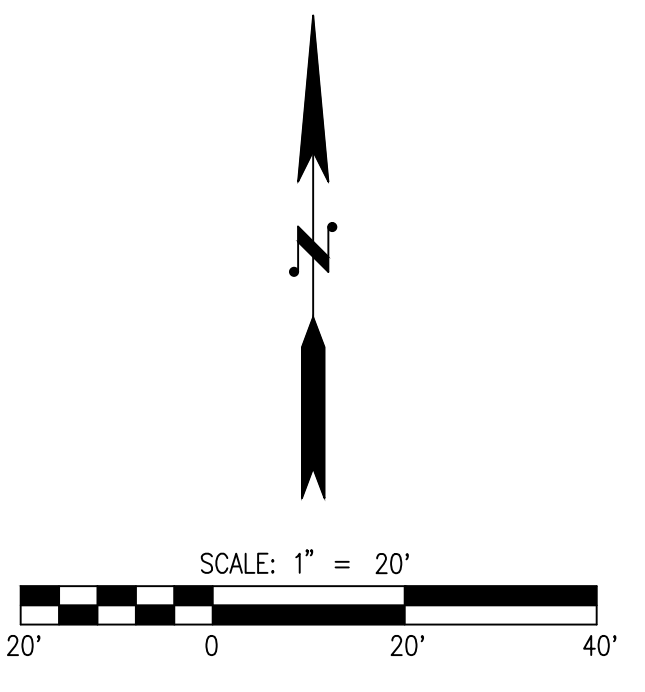

**LEGEND**

	PROPOSED DUCTILE IRON CL. 50 WATER LINE
	POST INDICATOR VALVE
	FIRE DEPARTMENT CONNECTION
	RPBA
	WATER METER
	GATE VALVE
	THRUST BLOCKING
	FIRE HYDRANT
	WATER BEND FITTING
	SANITARY SEWER CLEANOUT
	SANITARY SEWER MANHOLE
	ASTM D 3034 SDR 35 PVC SANITARY SEWER PIPE

<b>LDC</b>   Surveying Engineering Planning	
Woodinville Olympia 1411 State Avenue NE #200 Olympia, WA 98506 T 425.896.1869 www.LDCorp.com	Kent F 425.482.2893
<b>WA DEPARTMENT OF ENTERPRISE SERVICES</b>	
<b>PRITCHARD REHABILITATION AND EXPANSION</b>	
<b>WATER AND SEWER PLAN</b>	
JOB NUMBER: C22-261 DRAWING NAME: C22-261 UT-01 DESIGNER: RW DRAFTING BY: EO DATE: MARCH 2023 SCALE: AS NOTED JURISDICTION: OLYMPIA	
<b>UT-01</b>	
SHEET <b>6</b> OF <b>8</b>	



1

2

3

4

5

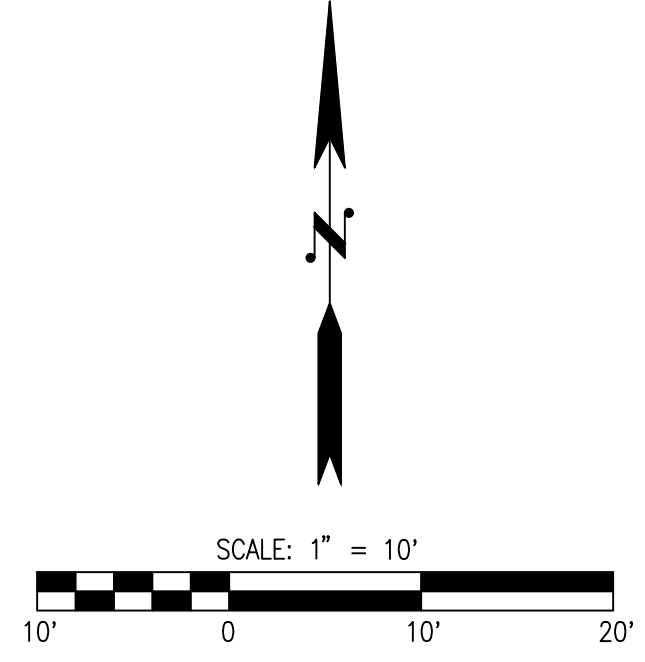
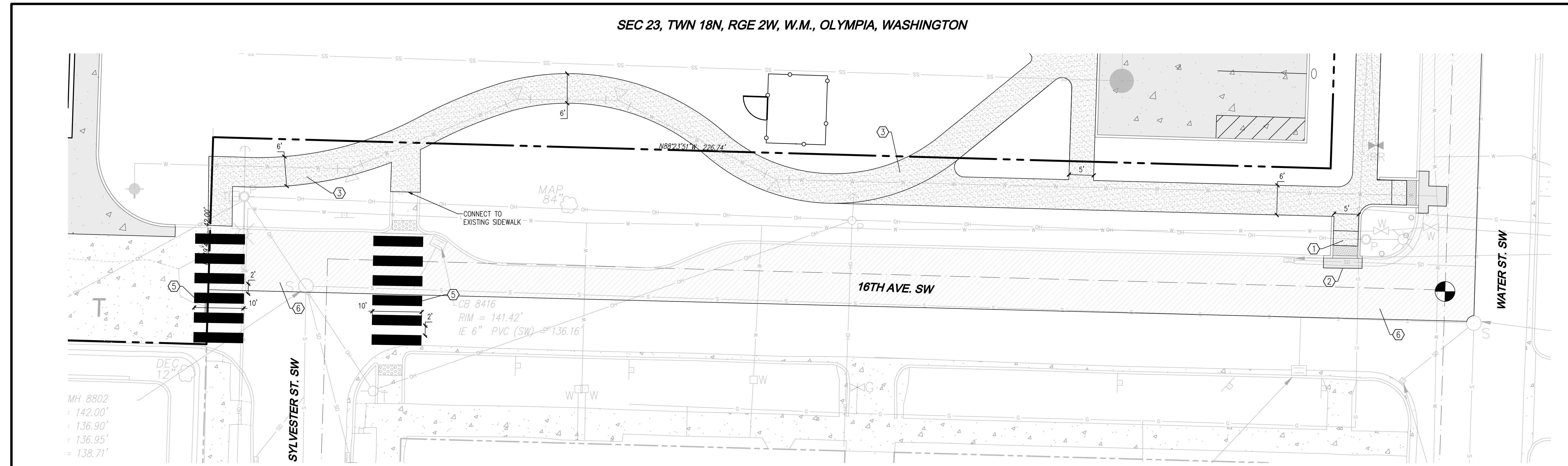

**LEGEND**

	PROPOSED BUILDING
	CONCRETE SIDEWALK
	ASPHALT PAVEMENT
	DECORATIVE CONCRETE PAVEMENT, SEE LANDSCAPE PLANS FOR ADDITIONAL INFORMATION
	GRIND & OVERLAY
	CONCRETE CURB

- NOTES**
1. INSTALL SINGLE DIRECTIONAL ADA RAMP
  2. INSTALL NEW ASPHALT PAVEMENT
  3. INSTALL CONCRETE SIDEWALK
  4. INSTALL NEW CONCRETE CURB
  5. INSTALL NEW CROSSWALK PAINT MARKINGS
  6. GRIND & OVERLAY

SEC 23, TWN 18N, RGE 2W, W.M., OLYMPIA, WASHINGTON

NO.	DATE	REVISIONS DESCRIPTION	BY

**LDC** | Surveying  
Engineering  
Planning

Woodinville  
1411 State Ave NE #200  
Olympia, WA 98506  
T 425.886.1869  
www.LDCcorp.com

Kent  
F 425.882.2893

WA DEPARTMENT OF ENTERPRISE SERVICES  
**PRITCHARD REHABILITATION AND EXPANSION**  
16TH AVE FRONTAGE IMPROVEMENTS

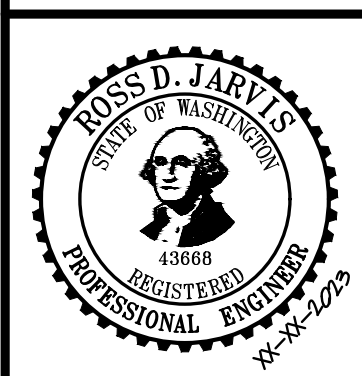

JOB NUMBER: C22-261  
DRAWING NAME: C22-261 FR-01  
DESIGNER: RW  
DRAFTING BY: EO  
DATE: MARCH 2023  
SCALE: AS NOTED  
JURISDICTION: OLYMPIA

**FR-01**  
SHEET 7 OF 8



**LDC** | Surveying  
Engineering  
Planning

Woodinville  
1411 State Ave NE #200  
Olympia, WA 98506  
T 425.886.1869  
www.LDCcorp.com

Kent  
F 425.882.2893

**PRITCHARD REHABILITATION AND EXPANSION**

100% SCHEMATIC DESIGN  
03/29/2023  
REVISIONS

73-22165-00  
16TH AVE FRONTAGE IMPROVEMENTS

FR-01

Drawing: P:\Civil\2022\C22-261 pritchard and expansion\Drawings\construction\C22-261 FR-01.dwg Plotfile: Mar 24, 2023 - 8:37am

Drawing: P:\Civil\2022\C22-261 pritchard and expansion\Drawings\construction\C22-261 FR-01.dwg Plotfile: Mar 24, 2023 - 8:37am



A

B

C

D

E

F

1

2

3

4

5

SEC 23, TWN 18N, RGE 2W, W.M., OLYMPIA, WASHINGTON

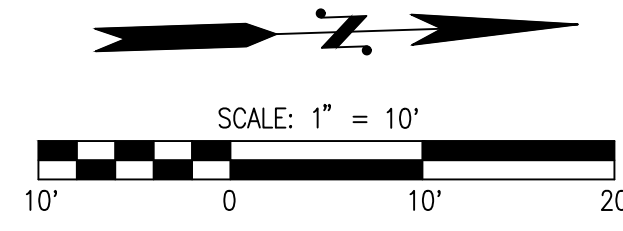
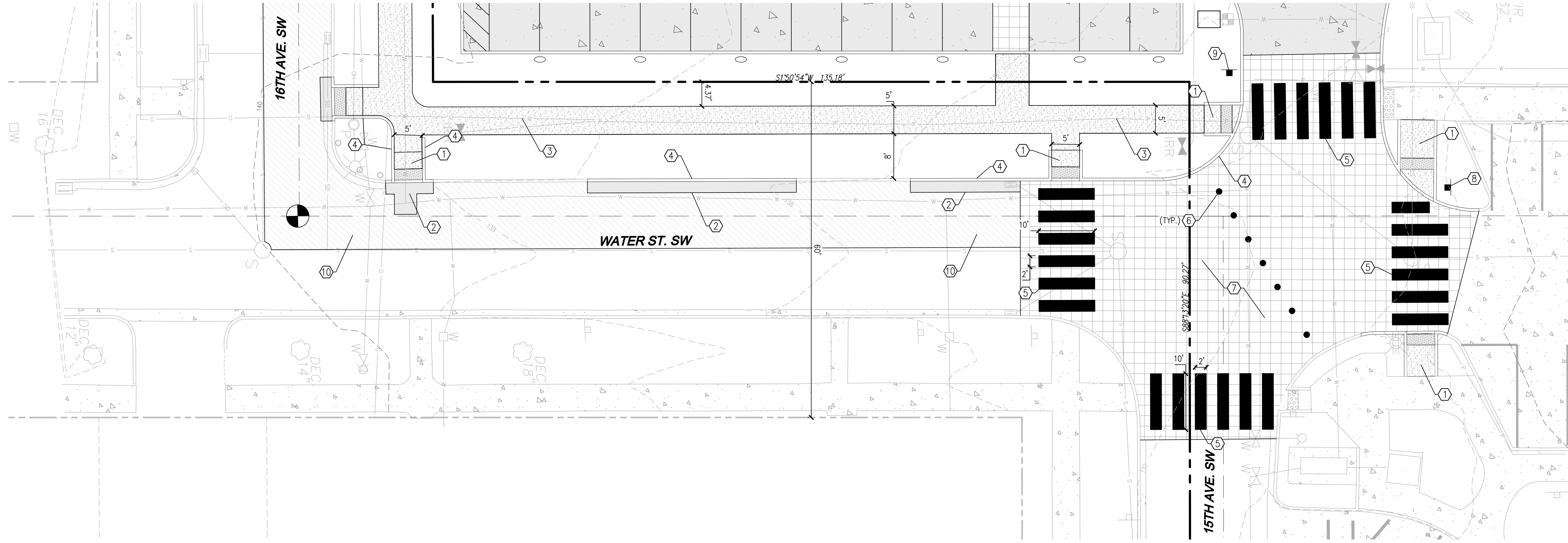

LEGEND

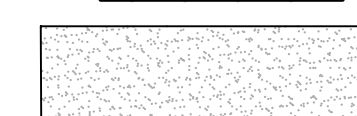
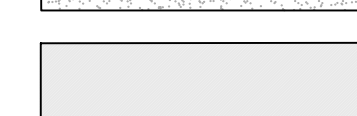
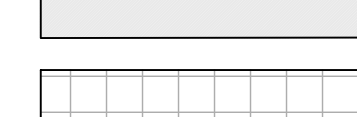
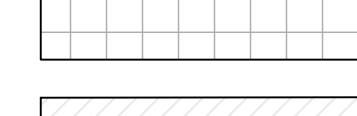
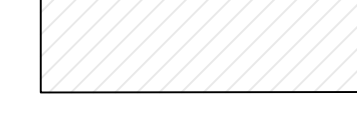
-  PROPOSED BUILDING
-  CONCRETE SIDEWALK
-  ASPHALT PAVEMENT
-  DECORATIVE CONCRETE PAVEMENT, SEE LANDSCAPE PLANS FOR ADDITIONAL INFORMATION
-  GRIND & OVERLAY
-  CONCRETE CURB

NOTES

1. INSTALL SINGLE DIRECTIONAL ADA RAMP
2. INSTALL NEW ASPHALT PAVEMENT
3. INSTALL CONCRETE SIDEWALK
4. INSTALL NEW CONCRETE CURB
5. INSTALL NEW CROSSWALK PAINT MARKINGS
6. INSTALL REMOVABLE BOLLARD
7. DECORATIVE CONCRETE PAVEMENT, SEE LANDSCAPE PLANS FOR ADDITIONAL INFORMATION
8. REINSTALL PEDESTRIAN CROSSING SIGN AND POST
9. REINSTALL STOP SIGN AND POST
10. GRIND & OVERLAY

NO.	DATE	DESCRIPTION	BY

**LDC** | Surveying  
Engineering  
Planning

Olympia, WA 98506  
1411 State Avenue #200  
Woodville, WA 98596  
T 425.896.1869  
www.LDCcorp.com

Kent  
F 425.482.2951

WA DEPARTMENT OF ENTERPRISE SERVICES  
**PRITCHARD REHABILITATION AND EXPANSION**  
WATER ST FRONTAGE IMPROVEMENTS

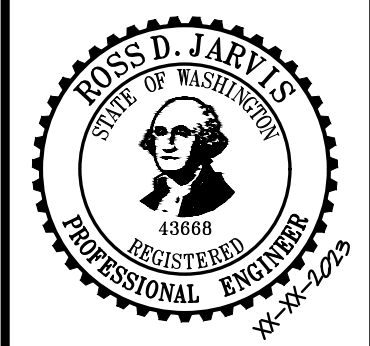

JOB NUMBER: C22-261  
DRAWING NAME: C22-261 FR-02  
DESIGNER: RW  
DRAFTING BY: EO  
DATE: MARCH 2023  
SCALE: AS NOTED  
JURISDICTION: OLYMPIA

FR-02

SHEET 8 OF 8

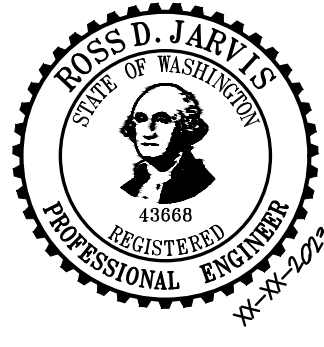

**LDC** | Surveying  
Engineering  
Planning

Olympia, WA 98506  
1411 State Avenue #200  
Woodville, WA 98596  
T 425.896.1869  
www.LDCcorp.com

Kent  
F 425.482.2951

100% SCHEMATIC DESIGN  
03/29/2023  
REVISIONS

**PRITCHARD REHABILITATION AND EXPANSION**  
WATER ST FRONTAGE IMPROVEMENTS

73-22165-00  
WATER ST  
FRONTAGE  
IMPROVEMENTS

FR-02

Drawing: F:\Civil\2022\C22-261 pritchard and expansion\Drawings\construction\C22-261 FR-02.dwg  
 Plotted: Mar 24, 2023 - 8:37am  
 Drawing: F:\Civil\2022\C22-261 pritchard and expansion\Drawings\construction\C22-261 FR-02.dwg  
 Plotted: Mar 24, 2023 - 8:37am