



Summit Pacific Medical Center

Expansion Project

Request for PRC Approval for:

GC/CM Project Delivery

Agenda-

September 22,2022 3:30 PM

- Intro-Presentation Participants - **Dick**
- SPMC Background/Why Expansion Project - **Josh/Tori**
- Project Team - **Dick**
- Project Scope - **PJ/Justin**
- Timeline - **Dick**
- Why GC/CM - **Dick**
- Questions - **Dick**
- Summary - **Josh/Tori**

SPMC - Josh/Tori

- Original Hospital-McCleary
- New Hospital Elma
- Expansion Clinic McCleary
- Wellness Center Elma-Used GC/CM 2017
- Ongoing Remodel Projects-Enhanced Service for Community
- Why Expansion Project-MFP 2.0

Project Team - Dick

- Summit Pacific Medical Center-Applicant/Owner-Key Staff
 - Josh Martin, Tori Bernier, Jim Hansen, Jeff Kruger, Jasmine Kling
- DBPM-Owner Rep/PM/CM
- Mahlum-AOR
- PAE-MEP
- Degenkolb-SE
- Jon Bayles-Construction Cost Consultant
- Perkins Coie-Contract Review
- Local Consultants-Civil, Survey, Geotech, SI, Commissioning

Project Scope - PJ/Justin



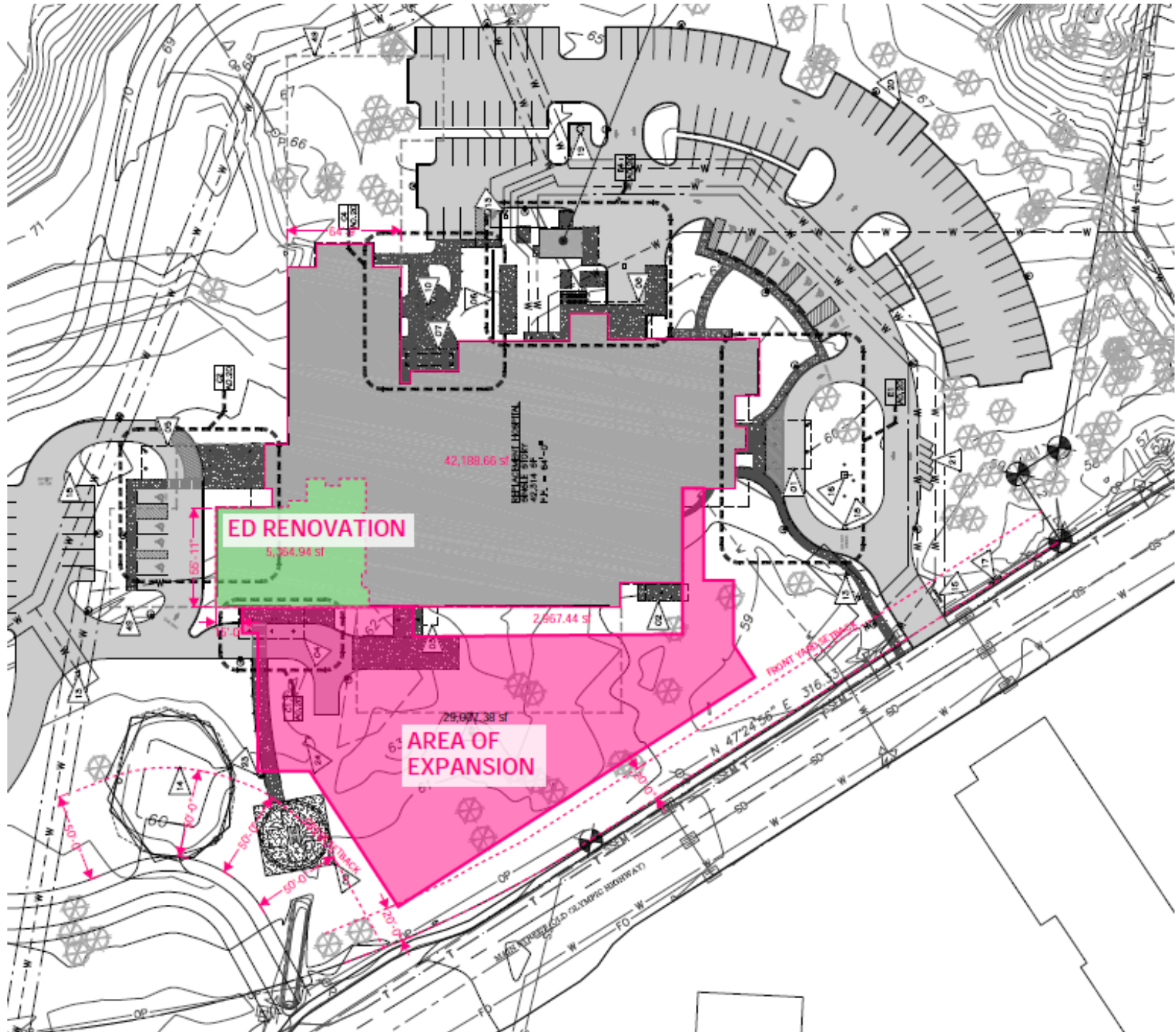

ED RENOVATION
5,354.94 sq ft

42,189.66 sq ft
REPLACEMENT HOSPITAL
42,189.66 sq ft
N 47°24'56" E 316.33'

AREA OF EXPANSION
29,007.38 sq ft

FRONT YARD 36' TRACK
N 47°24'56" E 316.33'

N 47°24'56" E 316.33'
N 47°24'56" E 316.33'
N 47°24'56" E 316.33'

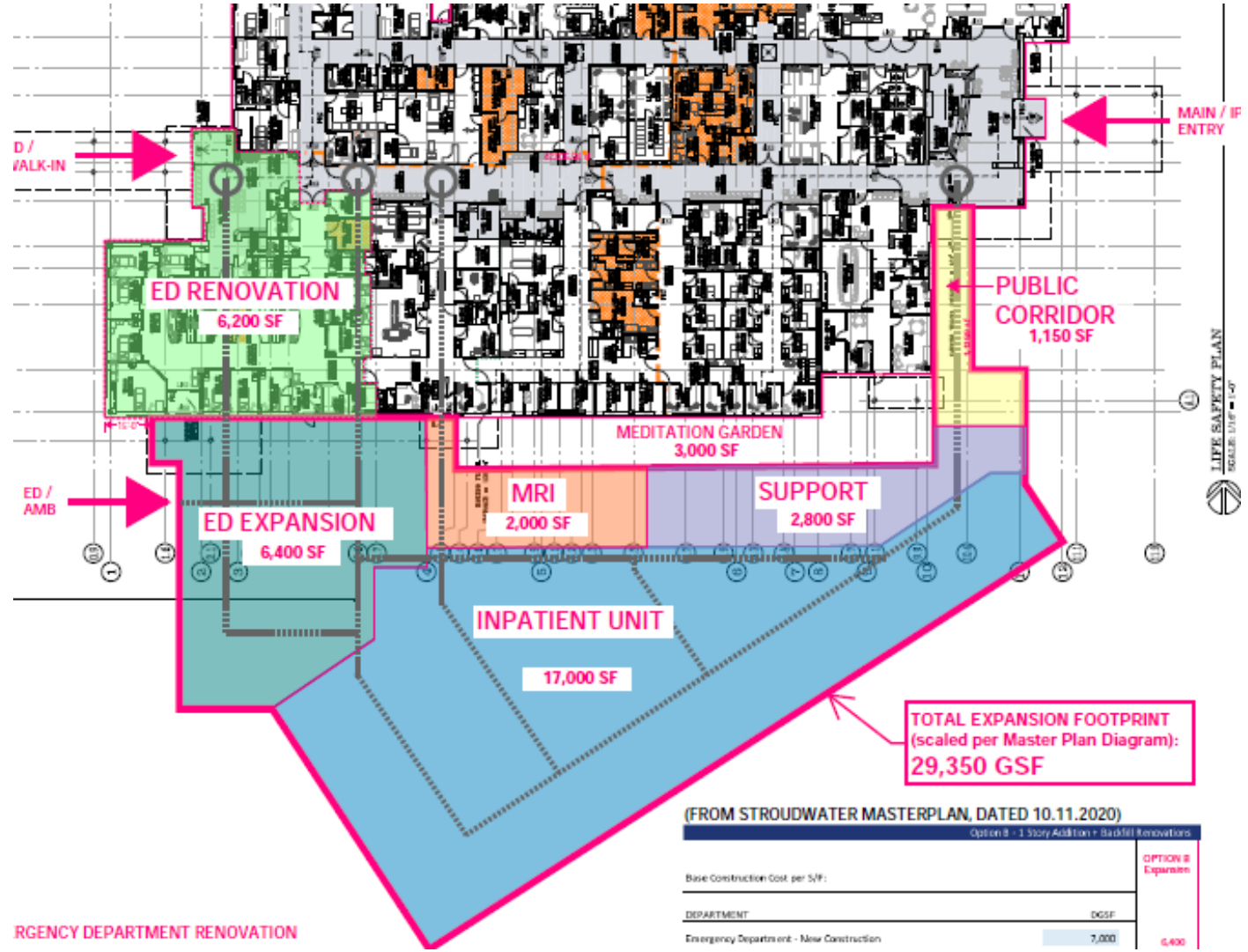

Timeline - Dick

Item	Task	Date
1	GC/CM Application Submittal	August 22, 2022
2	PRC Presentation	September 22, 2022
3	GC/CM Delivery Approval	September 22, 2022
5	GC/CM RFQ Due	October 20, 2022
6	GC/CM Interviews	October 30, 2022
7	GC/CM RFFP-Selection	November 2022
8	Schematic Design Complete	Q1 2023
9	Baseline Estimate	Q1 2023
10	GC/CM Budget - 70% DD	Q2 2023
11	VE/Constructability	Ongoing Design
12	Design Development Complete	Q2 2023
13	Baseline MACC 90% Constr. Docs	Q3 2023
14	Construction Docs 100%	Q4 2023
15	Permitting-Site/Building	Q4 2023
16	Final MACC	Q4 2023
17	Site Mobilization	Q1 2024
18	Construction Completion	Q2 2025

Why GC/CM - Dick

- Selection by Mid SD Phase
- Significant Integral Team Member-Expertise Critical to Success
- Establish Baseline Cost and Schedule
- Phasing Plan Consistent with **Facility Operations** and **Public Safety**
- Strategy in Material and Equipment Selections
- Design Phase Budget Updates
- Schedule and **Procurement Planning** During Design-Enhance Specs
- Constructability Analysis During Precon
- Scrub Design Prior to MACC Bidding Phase
- Cost Input Beneficial to Facilitate Financing Options

Summary - Dick/Josh/Tori

- Review Questions Previously Submitted by PRC-Dick
- SPMC Summary-Josh/Tori